

Technical Details	C220M	C405M
Dimensions (w,d,h mm)	762 x 620 x 500mm	762 x 620 x 500mm
Net Weight	85kg	105kg
Production Capacity (kg/24hr)*	220kg	405kg
Suggested Storage Bin	S230 (230kg)	S230 (230kg) or S390 (390kg)
Ice Cube Size	Full Dice 13 c.c. (22x22x22mm)	Full Dice 13 c.c. (22x22x22mm)
Cubes Per Cycle	200	400
Refrigerant	R404a	R404a
Climate Class	T (Tropical)	T (Tropical)
Condensation System	Air Cooled	Air Cooled
Inlet Connection	3/4" BSP	3/4" BSP
Electrical Connection	13amp	13amp
Electrical Rating	230V N+T 50hz	230V N+T 50hz
Power Rating	1200w	1800w
Operating Ranges		
Air Temperature	5°C - 40°C	5°C - 40°C
Water Temperature	5°C - 35°C	5°C - 35°C
Water Pressure	0.7 - 6 bar	0.7 - 6 bar
Options		
Half Dice Evaporator 6.5cc (22x11x22mm)	Optional	Optional
Union Kit	Optional	Optional
Water Filter	Optional	Optional



## C Series Modular

## Ice Makers

C 220M  
C 405M

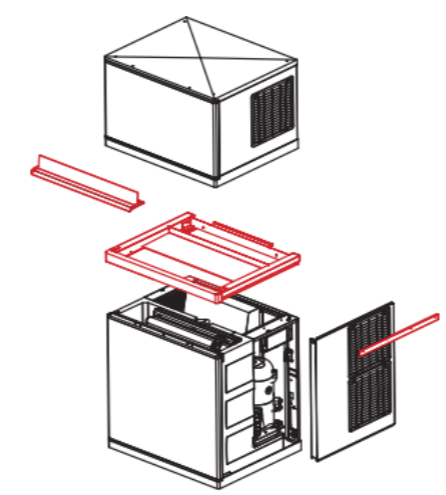

Optional Union Kit  
For Stacking 2 x Ice Machines

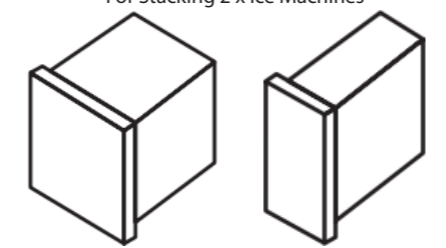

Full Dice Cube Standard  
22x22x22mm 13c.c.  
Half Dice Cube Optional  
22x11x22mm 6.5c.c.



Project Distribution Ltd  
Unit 1 Sun Street  
Stoke on Trent  
United Kingdom  
ST1 4JW  
01782 280289  
sales@project-distribution.co.uk  
www.prodis.co.uk

\*Production values calculated at 20°C ambient air temperature, 15°C water temperature





- Specifically designed to cope in even the most demanding venues.
- Classic 'dice' shaped ice cube.
- European manufactured to ISO9001 standards
- Proven and reliable ice production system
- Built in self cleaning cycle
- Units can be double stacked for venues where constant ice production is a must
- Highly reliable and familiar vertical evaporator production produces ice quickly and constantly
- 2 year parts warranty as standard

### C Series Modular

- A range of modular vertical evaporator production icemakers designed to perfectly complement our C series range.
- High volume ice production coupled with large storage bins designed to cope with even the most demanding venues.
- Full stainless steel construction for maximum durability.
- Tropicalised compressors to cope in even the most demanding environments up to 43°C
- Ice production values calculated at 20°C ambient temperature and 15°C water for realistic production values
- All machines produce a 'classic' dice ice cube, one of the most widely used ice cubes in the world.
- The C Series modular machines have a built in cleaning cycle for effortless hygiene

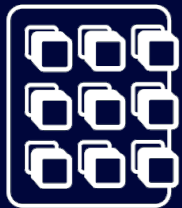

Vertical Evaporator System



C220M + S230 Silo



C405M + S390 Silo



2 x C220M + S230 Silo  
(requires union kit)



Economy Without Compromise

\*Production values calculated at 20°C ambient air temperature, 15°C water temperature

